

Addendum 2

37-15OCT13 - Boone County Walnut Office Columbia, MO

October 10, 2013 Addendum #2

The contract documents are amended as follows:

1. The General Contractor responsibilities shall include coordination with the owner's cost vendors (i.e. ARSI (Asbestos Removal), C&C Group (HVAC Controls), Inside the Lines (furniture), Steel-Nett LLC (cable pulling), ACC (security alarms), etc.)
2. All furniture shall be at owner cost
3. The modular walls shall be at owner cost. Owner's cost vendor shall install. Contractor shall coordinate installation with owner's cost vendor.
4. HVAC controls shall be at owner cost. Contractor shall coordinate installation with owner's cost vendor.
5. To clarify the extent of Alternate 3: Contractor shall remove and replace carpet and base and paint the entire 605 Walnut building.
 - a. The Contractor shall move files and furniture as needed to complete alternate 3.
6. There shall be tile on all sides of the wing wall in both restrooms to the same height as adjacent wall tile.
7. Tapered roof insulation is needed for cricket material and directing water to the drain, the general slope of the roof is created by the tapered trusses.
8. Roof insulation shall be Isocyanurate insulation as required by the roof membrane manufacturer warranty.
9. R-30 roof insulation is the minimum acceptable.
10. There shall be a 1 inch wrap insulation on the round duct.
11. Manko Window Systems is an acceptable storefront substitution
12. See attached revised sheet for the intent of sloping the existing parking lot.
13. See attached revised sheet E3.0 for revised panel schedule.

Prepared by:
Simon Associates Inc.

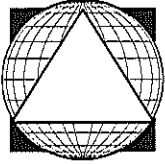

BOONE COUNTY WALNUT OFFICE

609 WALNUT ST. COLUMBIA MISSOURI

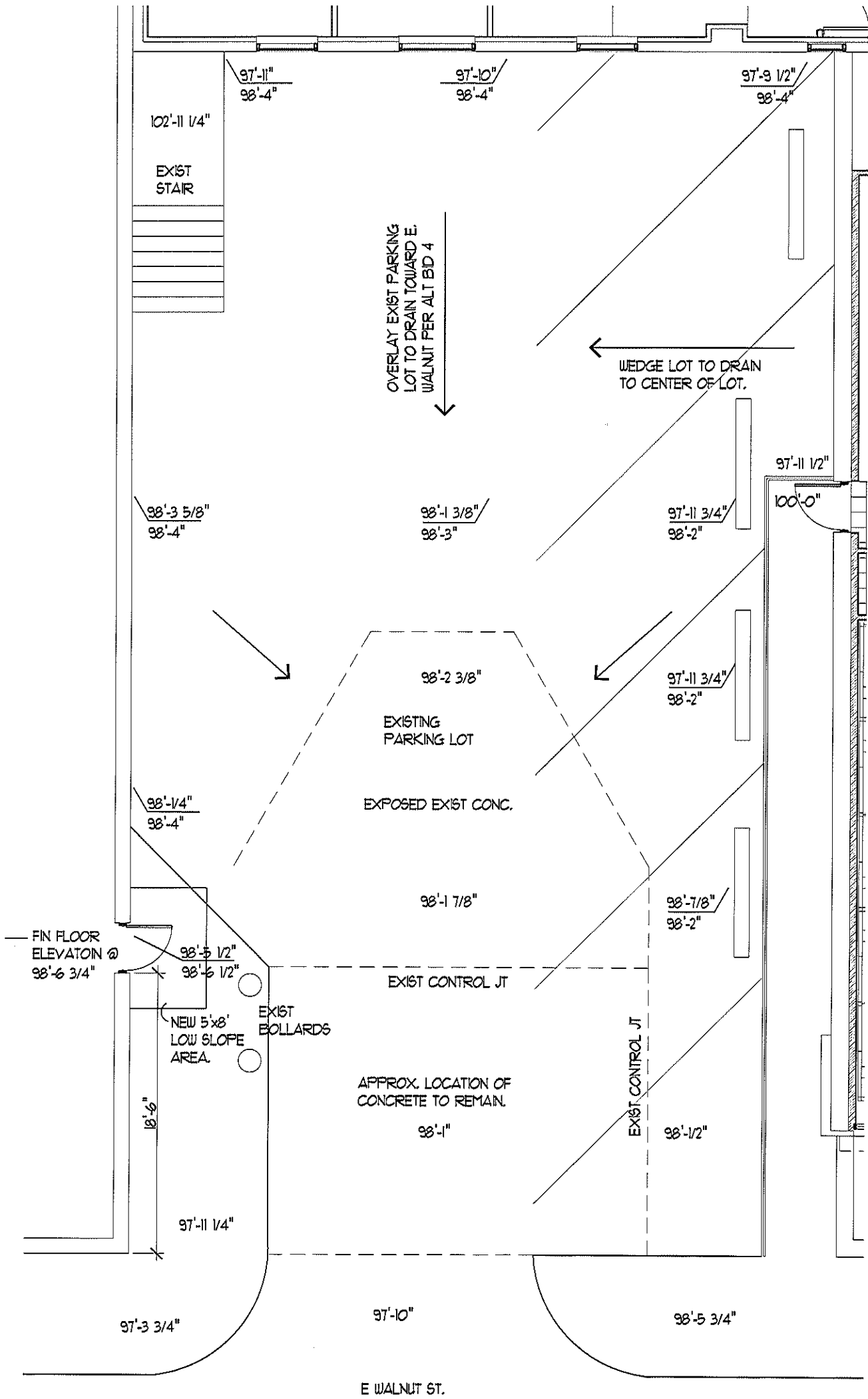

1 PARKING LOT DRAINAGE
 ADD2 SCALE: 1/8"=1'-0"

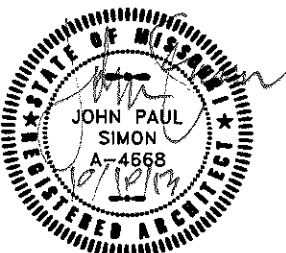

REVISIONS:

SIMON ASSOCIATES INC.

ARCHITECTURE
 13 South Sixth Street Columbia, Missouri Phone: 573-874-1018 Fax: 573-499-8887

THIS DOCUMENT IS THE PROPERTY OF THE ARCHITECT AND MAY NOT BE REPRODUCED

DATE ISSUED: 10/10/15

DRAWINGS ARE THE PROPERTY OF TIMBERLAKE ENGINEERING AND MAY NOT BE COPIED OR USED IN WHOLE OR PART WITHOUT THE WRITTEN PERMISSION OF TIMBERLAKE ENGINEERING.

DO NOT SCALE THIS DRAWING. SOME DEVIATION FROM SCALE MAY OCCUR.

REVISIONS:	DATE:
REVISED PANEL 'P1' SCHEDULE	10-8-2013

THE PROFESSIONAL ENGINEER'S SEAL ON THIS DRAWING HAS BEEN AFFIXED IN ACCORDANCE WITH THE REQUIREMENTS OF CHAPTER 327, RSMO. IN AFFIXING THIS SEAL THE ENGINEER TAKES RESPONSIBILITY FOR THE WORK SHOWN ON THIS DRAWING ONLY, AND HEREBY DISCLAIMS ANY AND ALL RESPONSIBILITY FOR OTHER PROJECT DRAWINGS NOT DIRECTLY BEARING THIS SEAL.

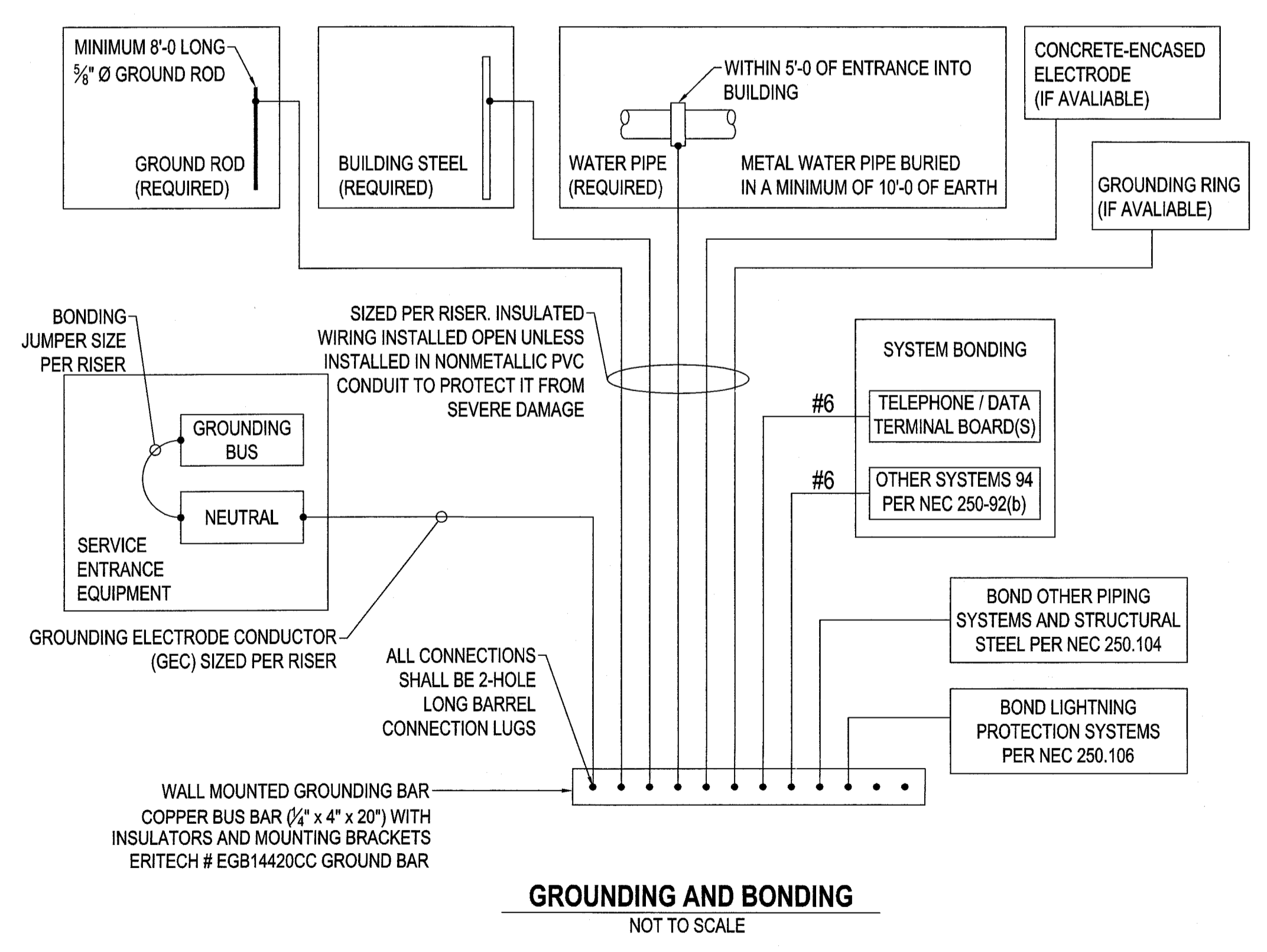
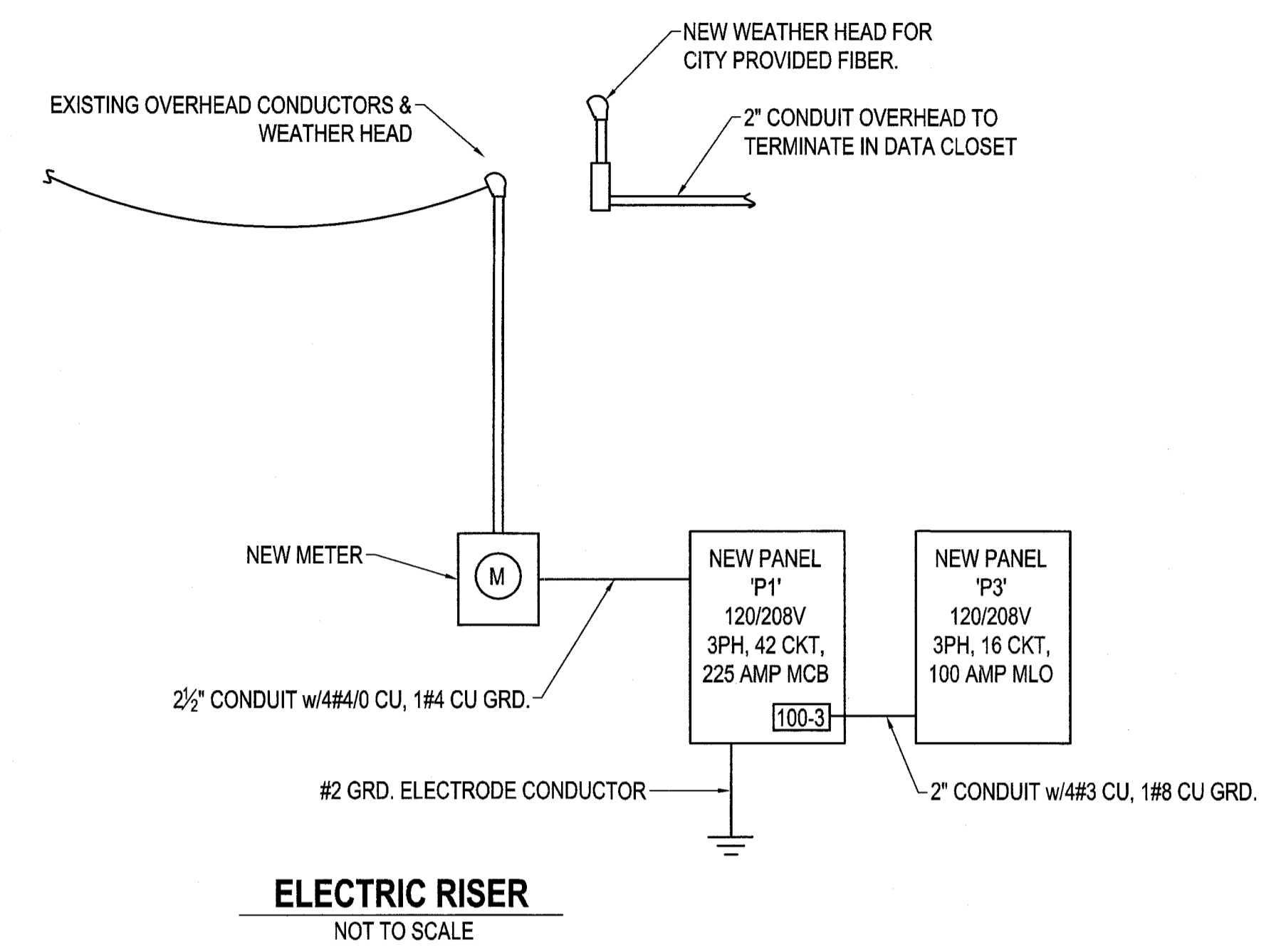

ELECTRICAL PANEL SCHEDULE							PANEL NO. P1	
VOLTS:	208	MAIN CAPACITY:	225 MCB			"A" AMPS= 162.5		
PHASE:	3	MOUNTING:	RECESSED			"B" AMPS= 154.5		
WIRE:	SEE RISER	BUSS MATERIAL:	COPPER			"C" AMPS= 178.5		
AIR:	SEE RISER	SQUARE D MODEL:	QO					
CKT.	LOCATION/DESC.	BREAKER	AMPS	PH.	AMPS	BREAKER	LOCATION/DESC.	CKT.
1	RESTROOM/HALL RECEPTACLES	20-1	7.5	A	33	80-3	RTU-1	2
3	REFRIGERATOR	20-1	12	B	33	\	\	4
5	GARBAGE DISPOSAL	20-1	5	C	33	\	\	6
7	COUNTER RECPTACLES	20-1	3	A	14	20-1	LIGHTS	8
9	CONFERENCE ROOM RECEPTACLES	20-1	9	B	14	20-1	LIGHTS	10
11	CONFERENCE ROOM IN-FLOOR RECEPTACLES	20-1	3	C	4.5	20-1	JANITOR CLOSET	12
13	OFFICE RECEPTACLES	20-1	5	A	1.5	100-3	P-3	14
15	WORK STATION RECEPTACLES	20-1	7.5	B	1.5	\	\	16
17	SOUTH WALL RECEPTACLES	20-1	7.5	C	1.5	\	\	18
19	WORK STATION RECEPTACLES	20-1	7.5	A	1.5	20-1	CEILING J-BOX	20
21	WORK STATION RECEPTACLES	20-1	7.5	B	1.5	20-1	CEILING J-BOX	22
23	WORK STATION RECEPTACLES	20-1	4.5	C	1.5	20-1	CEILING J-BOX	24
25	WORK STATION RECEPTACLES	20-1	6	A	1.5	20-1	CEILING J-BOX	26
27	WH-1	20-2	15	B	1.5	20-1	CEILING J-BOX	28
29	\	\	15	C	3	20-1	DATA CLOSET	30
31	GRINDER PUMP	20-1	15	A	22	30-2	FTU-3	32
33	\	\	15	B	22	\	\	34
35	FTU-1	60-2	40	C	5	20-2	FTU-4	36
37	\	\	40	A	5	\	\	38
39	FTU-2	50-2	38	B	17	30-2	FTU-5	40
41	\	\	38	C	17	\	\	42

NOTE: ELECTRICIAN TO VERIFY ALL EQUIPMENT POWER REQUIREMENTS PRIOR TO ANY EQUIPMENT & BREAKER PURCHASE OR INSTALLATION.

ELECTRICAL PANEL SCHEDULE							PANEL NO. P3	
VOLTS:	208	MAIN CAPACITY:	100 MLO			"A" AMPS= 1.5		
PHASE:	3	MOUNTING:	RECESSED			"B" AMPS= 1.5		
WIRE:	SEE RISER	BUSS MATERIAL:	COPPER			"C" AMPS= 1.5		
AIR:	SEE RISER	SQUARE D MODEL:	QO					
CKT.	LOCATION/DESC.	BREAKER	AMPS	PH.	AMPS	BREAKER	LOCATION/DESC.	CKT.
1	CEILING J-BOX	20-1	1.5	A		20-1	SPARE	2
3	CEILING J-BOX	20-1	1.5	B		20-1	SPARE	4
5	CEILING J-BOX	20-1	1.5	C		20-1	SPARE	6
7	SPARE	20-1		A		20-1	SPARE	8
9	SPARE	20-1		B		20-1	SPARE	10
11	SPARE	20-1		C		20-1	SPARE	12
13	SPARE	20-1		A		20-1	SPARE	14
15	SPARE	20-1		B		20-1	SPARE	16

NOTE: ELECTRICIAN TO VERIFY ALL EQUIPMENT POWER REQUIREMENTS PRIOR TO ANY EQUIPMENT & BREAKER PURCHASE OR INSTALLATION.

STATE OF MISSOURI
REGISTERED PROFESSIONAL ENGINEER
MARK B. TIMBERLAKE
NUMBER E22105
10/9/2013
Mark Timberlake, P.E. E-22105 Date

TIMBERLAKE ENGINEERING, P.C.
1100 EAST WALNUT COLUMBIA, MO 65201 (573) 875-4365 CERTIFICATE OF AUTHORITY #: 2006012388

POWER DETAILS & SCHEDULES

BOONE COUNTY WALNUT OFFICE

609 E WALNUT STREET COLUMBIA, MO
DATE: 9-16-2013 SHEET NO.
DRAWN BY: KMH
DESIGNED/CHECKED BY: JPW
PROJECT NO: 13181
SCALE: N/A

E3.0